

PRODUCT INFO Heatit eezedim 2P 250W

FEATURES

- 2-poled rotary dimmer
- 4-wire
- Connection of both phases (2-pole break)
- 5W - 250W LED
- Trailing edge
- Min. dim level

NB! Dimming may be challenging, and we recommend checking the compatibility of different light sources before installation.

TECHNICAL DATA

Rated voltage	230VAC 50Hz
Power	5W - 250W
Controls	Rotary dimming
Ambient temperature	5°C to 40°C
Connection	Max. 2.5mm ²
Flush mounting depth	24mm
IP Code	IP 21
Size (LxWxH)	84 x 84 x 43mm

Approvals CE

MAINTENANCE

The device is maintenance-free, but must never be covered. Only for indoor installation.

WARRANTY 2 years

HEATIT EEZEDIM 2P

- 2-poled rotary dimmer 250W



White RAL 9010

14 444 31

HEATIT EEZEDIM 2P 250W

Heatit eezedim 2P is a 2-poled rotary dimmer for dimming lights in bathrooms and other rooms requiring a 2-pole switch. Can be used for incandescent lamps, electronic transformers, 230VAC halogen lamps or LEDs.

Heatit eezedim 2P is very well suited for LED, and fits into System 55 frames. When connecting low loads it is recommended to use a bypass.

Included in package



1x White RAL 9010 plastic kit



Dimmer unit

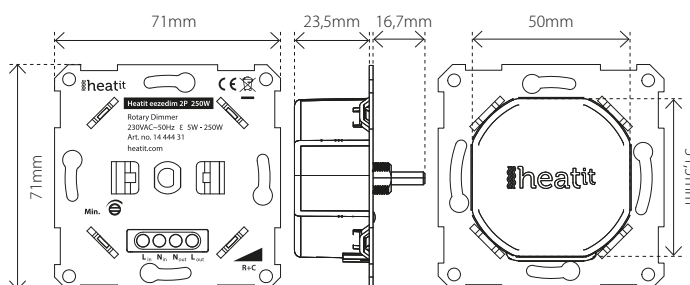

ART. NO.	PRODUCT	COLOR
14 444 31	Heatit eezedim 2P 250W	White RAL 9010